

SOCKET WELDING FITTINGS - fittinguri mufa soclu

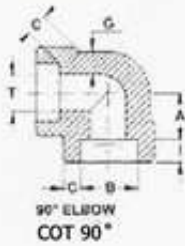

To ANSI B 16.11

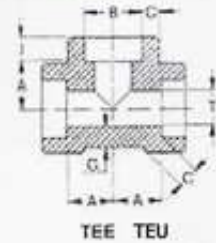

RATING CLASA	INCH	NOMINAL PIPE SIZE					Ø DIMENSIUNI							
		1/8	1/4	3/8	1/2	3/4	1	1 1/4	1 1/2	2	2 1/2	3	4	
3000 LB	A	max	11.9	11.9	15.0	17.2	20.5	24.4	28.9	33.8	40.1	43.7	59.7	69.1
		min	10.4	10.4	12.0	14.2	17.5	20.3	24.9	29.7	36.1	38.6	54.6	64.0
	C	max	3.2	3.8	4.0	4.7	4.9	5.7	6.1	6.4	6.9	8.8	9.5	10.7
		min	3.2	3.3	3.5	4.1	4.3	5.0	5.3	5.5	6.0	7.7	8.3	9.3
	G	min	2.4	3.0	3.2	3.7	3.9	4.5	4.9	5.1	5.5	7.0	7.6	8.6
T	max	7.6	10.0	13.3	16.6	21.7	27.4	35.8	41.6	53.3	64.2	79.5	103.8	
	min	6.1	8.5	11.8	15.0	20.2	25.9	34.3	40.1	51.7	61.2	76.4	100.7	
6000 LB	A	max	11.9	15.0	17.2	20.5	24.4	28.9	33.8	40.1	43.6	59.6	67.0	82.2
		min	10.4	12.0	14.2	17.5	20.3	24.9	29.7	36.1	38.6	54.6	61.0	76.2
	C	max	4.0	4.6	5.0	6.0	7.0	7.9	7.9	8.9	10.9	11.9	13.9	16.9
		min	3.4	4.0	4.4	5.2	6.0	6.9	6.9	7.8	9.5	10.4	12.2	14.8
	G	min	3.1	3.7	4.0	4.8	5.6	6.3	6.3	7.1	8.7	9.6	11.2	13.6
T	max	4.8	7.1	9.9	12.5	16.3	21.5	30.2	34.7	43.6	54.8	66.3	88.0	
	min	3.2	5.6	8.4	11.0	14.8	19.9	28.7	33.2	42.1	53.3	64.8	86.5	
SOCKET	B	max	10.9	14.3	17.8	22.0	27.3	34.1	42.8	48.9	61.4	74.2	90.2	115.8
		min	10.7	14.1	17.5	21.7	27.0	33.8	42.5	48.6	61.1	73.8	89.8	115.4
	J	min	9.7	9.7	9.7	9.7	12.7	12.7	12.7	15.7	15.7	15.7	19.0	

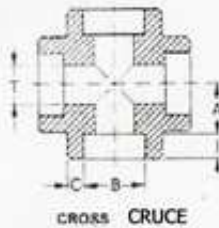

To ANSI B 16.11

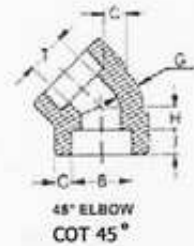

RATING CLASA	INCH	NOMINAL PIPE SIZE					Ø DIMENSIUNI							
		1/8	1/4	3/8	1/2	3/4	1	1 1/4	1 1/2	2	2 1/2	3	4	
3000 LB	A	max	11.9	11.9	15.0	17.2	20.5	24.4	28.9	33.8	40.1	43.7	59.7	69.1
		min	10.4	10.4	12.0	14.2	17.5	20.3	24.9	29.7	36.1	38.6	54.6	64.0
	C	max	3.2	3.8	4.0	4.7	4.9	5.7	6.1	6.4	6.9	8.8	9.5	10.7
		min	3.2	3.3	3.5	4.1	4.3	5.0	5.3	5.5	6.0	7.7	8.3	9.3
	G	min	2.4	3.0	3.2	3.7	3.9	4.5	4.9	5.1	5.5	7.0	7.6	8.6
T	max	7.6	10.0	13.3	16.6	21.7	27.4	35.8	41.6	53.3	64.2	79.5	103.8	
	min	6.1	8.5	11.8	15.0	20.2	25.9	34.3	40.1	51.7	61.2	76.4	100.7	
6000 LB	A	max	11.9	15.0	17.2	20.5	24.4	28.9	33.8	40.1	43.6	59.6	67.0	82.2
		min	10.4	12.0	14.2	17.5	20.3	24.9	29.7	36.1	38.6	54.6	61.0	76.2
	C	max	4.0	4.6	5.0	6.0	7.0	7.9	7.9	8.9	10.9	11.9	13.9	16.9
		min	3.4	4.0	4.4	5.2	6.0	6.9	6.9	7.8	9.5	10.4	12.2	14.8
	G	min	3.1	3.7	4.0	4.8	5.6	6.3	6.3	7.1	8.7	9.6	11.2	13.6
T	max	4.8	7.1	9.9	12.5	16.3	21.5	30.2	34.7	43.6	54.8	66.3	88.0	
	min	3.2	5.6	8.4	11.0	14.8	19.9	28.7	33.2	42.1	53.3	64.8	86.5	
SOCKET	B	max	10.9	14.3	17.8	22.0	27.3	34.1	42.8	48.9	61.4	74.2	90.2	115.8
		min	10.7	14.1	17.5	21.7	27.0	33.8	42.5	48.6	61.1	73.8	89.8	115.4
	J	min	9.7	9.7	9.7	9.7	12.7	12.7	12.7	15.7	15.7	15.7	19.0	

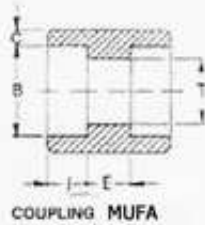

COUPLING MUFA

To ANSI B 16.11

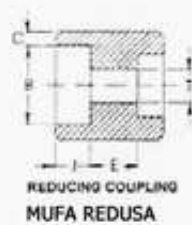

REDUCING COUPLING
MUFA REDUSA

To ANSI B 16.11

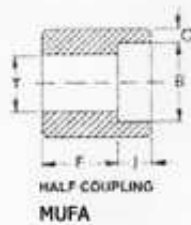

HALF COUPLING
MUFA

To ANSI B 16.11



CAP
CAPAC

To ANSI B 16.11

RATING CLASA	INCH	NOMINAL PIPE SIZE				Ø DIMENSIUNI								
		1/8	1/4	3/8	1/2	3/4	1	1 1/4	1 1/2	2	2 1/2	3	4	
3000 LB	C	ave	3.2	3.8	4.0	4.7	4.9	5.7	6.1	6.4	6.9	8.8	9.5	10.7
		min	3.2	3.3	3.5	4.1	4.3	5.0	5.3	5.5	6.0	7.7	8.3	9.3
	E	max	7.9	7.9	9.4	12.7	12.7	16.8	16.8	16.8	23.1	24.1	24.1	24.1
		min	4.8	4.8	3.3	6.6	6.6	8.6	8.6	8.6	15.0	14.0	14.0	14.0
	F	max	16.5	16.5	19.0	23.9	25.4	30.5	32.3	33.8	43.2	45.5	47.0	50.3
		min	15.0	15.0	16.0	20.8	22.4	26.4	28.2	29.7	39.1	40.4	41.9	45.2
G	min	4.0	7.0	7.0	8.0	10.0	11.0	13.0	14.0	18.0	21.0	24.0	30.0	
	T	max	7.6	10.0	13.3	16.6	21.7	27.4	35.8	41.6	53.3	64.2	79.5	103.8
		min	6.1	8.5	11.8	15.0	20.2	25.9	34.3	40.1	51.7	61.2	76.4	100.7
6000 LB	C	ave	4.0	4.6	5.0	6.0	7.0	7.9	7.9	8.9	10.9	11.9	13.9	16.9
		min	3.4	4.0	4.4	5.2	6.0	6.9	6.9	7.8	9.5	10.4	12.2	14.8
	E	max	7.9	7.9	9.4	12.7	12.7	16.8	16.8	16.8	23.1	24.1	24.1	24.1
		min	4.8	4.8	3.3	6.6	6.6	8.6	8.6	8.6	15.0	14.0	14.0	14.0
	F	max	16.5	16.5	19.0	23.9	25.4	30.5	32.3	33.8	43.2	45.5	47.0	50.3
		min	15.0	15.0	16.0	20.8	22.4	26.4	28.2	29.7	39.1	40.4	41.9	45.2
G	min	6.0	8.0	10.0	11.0	13.0	14.0	18.0	19.0	24.0	29.0	34.0	44.0	
	T	max	4.8	7.1	9.9	12.5	16.3	21.5	30.2	34.7	43.6	54.8	66.3	88.0
		min	3.2	5.6	8.4	11.0	14.8	19.9	28.7	33.2	42.1	53.3	64.8	86.5
SOCKET	B	max	10.9	14.3	17.8	22.0	27.3	34.1	42.8	48.9	61.4	74.2	90.2	115.8
		min	10.7	14.1	17.5	21.7	27.0	33.8	42.5	48.6	61.1	73.8	89.8	115.4
	J	min	9.7	9.7	9.7	9.7	12.7	12.7	12.7	12.7	15.7	15.7	15.7	19.0

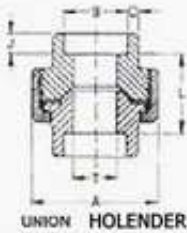

UNION HOLENDER

To ANSI B 16.11

RATING CLASA	INCH	NOMINAL PIPE SIZE				Ø DIMENSIUNI									
		1/8	1/4	3/8	1/2	3/4	1	1 1/4	1 1/2	2	2 1/2	3	4		
3000 LB	A	nom	35.0	35.0	40.0	46.0	55.5	64.5	78.0	87.0	104.0	124.0	150.0	187.0	
		C	ave	3.2	3.8	4.0	4.7	4.9	5.7	6.1	6.4	6.9	8.8	9.5	10.7
			min	3.2	3.3	3.5	4.1	4.3	5.0	5.3	5.5	6.0	7.7	8.3	9.3
	L	max	22.4	22.4	26.9	26.9	31.8	34.3	40.6	42.2	45.5	61.7	63.8	97.0	
		min	19.0	19.0	20.6	20.6	25.4	26.2	32.5	34.0	37.3	52.1	53.6	85.0	
	T	max	6.8	9.8	13.9	17.5	21.8	28.1	35.8	41.6	52.5	64.7	77.7	102.8	
min		6.4	9.4	13.5	17.1	21.4	27.7	35.4	41.2	52.1	64.3	77.3	100.7		
6000 LB	A	nom	-	46.0	46.0	64.5	64.5	87.0	87.0	104.0	124.0	-	-	-	
		C	ave	-	4.6	5.0	6.0	7.0	7.9	7.9	8.9	10.9	-	-	-
			min	-	4.0	4.4	5.2	6.0	6.9	6.9	7.8	9.5	-	-	-
	L	max	-	31.0	31.0	38.0	35.5	46.0	43.5	52.5	81.0	-	-	-	
		min	-	28.5	28.5	36.0	33.0	43.0	40.0	48.0	75.0	-	-	-	
	T	max	-	7.1	9.9	12.5	16.3	21.5	30.2	34.7	43.6	-	-	-	
min		-	5.6	8.4	11.0	14.8	19.9	28.7	33.2	42.1	-	-	-		
SOCKET	B	max	10.9	14.3	17.8	22.0	27.3	34.1	42.8	48.9	61.4	74.2	90.2	115.8	
		min	10.7	14.1	17.5	21.7	27.0	33.8	42.5	48.6	61.1	73.8	89.8	115.4	
	J	min	9.7	9.7	9.7	9.7	12.7	12.7	12.7	12.7	15.7	15.7	15.7	19.0	

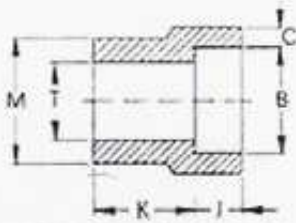

REDUCER INSERT TYPE 1

STANDARD DIMENSIONS

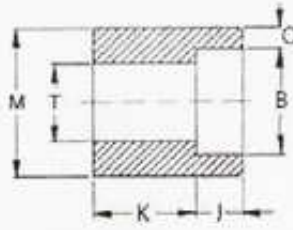

REDUCER INSERT TYPE 2

STANDARD DIMENSIONS

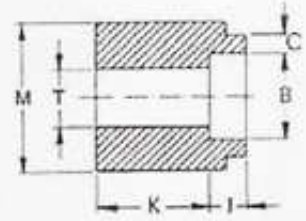

REDUCER INSERT TYPE 3

STANDARD DIMENSIONS

RATING/clasa 3000 lb																						
inch		NOMINAL PIPE SIZE Ø dimensiuni																				
		1/2			3/4			1			1 ¼			1 ½			2			2 ½		
		type			type			type			type			type			type					
		1	2	3	1	2	3	1	2	3	1	2	3	1	2	3	1	2	3	1	2	3
K	1/4						15.7															
	3/8	23.9																				
	1/2						26.9															
	3/4																					
	1																					
	1 ¼																					
	1 ½																					
	2																					
M																						
C	ave																					
	min																					
T	max																					
	min																					

RATING/clasa 6000 lb																						
inch		NOMINAL PIPE SIZE Ø dimensiuni																				
		1/2			3/4			1			1 ¼			1 ½			2			2 ½		
		type			type			type			type			type			type					
		1	2	3	1	2	3	1	2	3	1	2	3	1	2	3	1	2	3	1	2	3
K	1/4	30.2																				
	3/8	30.2																				
	1/2																					
	3/4																					
	1																					
	1 ¼																					
	1 ½																					
	2																					
M																						
C	ave																					
	min																					
T	max																					
	min																					

SOCKET																						
B	min																					
	max																					
J	min																					

		3000 lb		6000 lb	
		1/4	3/8	1/4	3/8
C	ave	3.8	4.0	4.6	5.0
	min	3.3	3.5	4.0	4.4
T	max	10.0	13.3	7.1	9.9
	min	8.5	11.8	5.6	8.4
B	max	14.3	17.8	14.3	17.8
	min	14.1	17.5	14.1	17.5
J	min	9.7	9.7	9.7	9.7

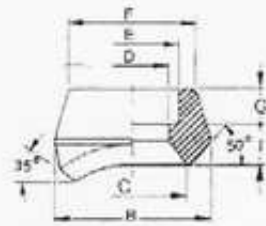

SOCKET BRANCH

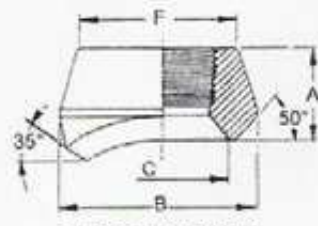

THREADED BRANCH

STANDARD DIMENSIONS

RATING CLASA	inch	NOMINAL PIPE SIZE						Ø DIMENSIUNI					
		1/8	1/4	3/8	1/2	3/4	1	1 1/4	1 1/2	2	2 1/2	3	4
3000 lb	A	17.5	17.5	20.6	25.4	27.0	33.3	33.3	34.9	38.1	46.0	50.8	57.1
	B	25.4	25.4	31.8	34.9	44.5	54.0	65.1	73.0	88.9	103.2	122.2	152.4
	C	15.9	15.9	19.0	23.8	30.2	36.5	44.5	50.8	65.1	76.2	93.7	120.6
	D	6.8	9.2	12.5	15.8	20.9	26.6	35.0	40.9	52.5	62.7	77.9	102.3
	E	10.7	14.1	17.5	21.7	27.0	33.8	42.6	48.6	61.1	73.8	89.8	115.4
	F	22.2	22.2	25.4	31.7	36.5	46.0	55.6	61.9	74.6	87.3	104.8	130.2
	G	9.5	9.5	9.5	11.1	12.7	13.5	15.1	15.1	17.5	23.8	28.6	29.4
	I	8.0	8.0	11.1	14.3	14.3	19.8	18.2	19.8	20.6	22.2	22.2	27.7
6000 lb	A	-	-	-	31.7	36.5	39.7	41.3	42.8	58.7	-	-	-
	B	-	-	-	44.5	50.8	61.9	69.9	82.6	103.2	-	-	-
	C	-	-	-	19.0	25.4	33.3	38.1	49.2	58.7	-	-	-
	D	-	-	-	14.3	19.0	25.4	33.3	38.1	42.9	-	-	-
	E	-	-	-	21.7	27.0	33.8	42.6	48.6	61.1	-	-	-
	F	-	-	-	36.7	45.2	57.1	65.1	76.2	92.1	-	-	-
	G	-	-	-	9.5	14.3	15.9	20.6	20.6	22.2	-	-	-
	I	-	-	-	22.2	22.2	23.8	20.6	22.2	36.5	-	-	-



WELD BRANCHE 160-XXS

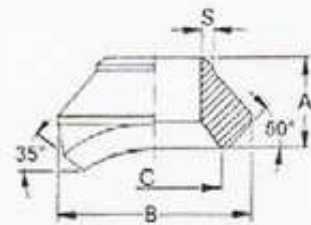

WELD BRANCHE STD-XS

STANDARD DIMENSIONS

TYPE/ SCHEDULE	inch	NOMINAL PIPE SIZE						Ø DIMENSIUNI					
		1/8	1/4	3/8	1/2	3/4	1	1 1/4	1 1/2	2	2 1/2	3	4
STANDARD WEIGHT AND EXTRA STRONG	A	14.3	14.3	19.0	19.0	22.2	27.0	31.7	33.3	38.1	41.3	44.4	50.8
	B	25.4	25.4	31.7	34.9	44.5	54.0	65.1	73.0	88.9	103.2	122.2	152.4
	C	15.9	15.9	19.0	23.8	30.2	36.5	44.5	50.8	65.1	76.2	93.7	120.6
SCHEDULE 160 AND DOUBLE EXTRA STRONG	A	-	-	-	28.6	31.7	38.1	44.5	50.8	55.6	61.9	73.0	84.1
	B	-	-	-	34.9	44.5	50.8	61.9	69.9	81.0	96.8	120.6	152.4
	C	-	-	-	14.3	19.0	25.4	33.3	38.1	42.9	54.0	73.0	98.4

WEIGHTS TABLE (unit in grammes) - tabel greutati (in Kg)
SOCKETS-WELDINGS FITTINGS – fitinguri mufa soclu

TYPE /RATING	Inch	1/8	1/4	3/8	1/2	3/4	1	1 ¼	1 ½	2	2 ½	3	4
90° ELBOW cot 90°	3000	0,100	0,095	0,130	0,245	0,320	0,470	0,765	0,980	1,640	2,935	4,525	11,500
	6000	0,100	0,160	0,290	0,415	0,680	1,150	1,380	2,680	3,215	5,850	8,400	15,500
45° ELBOW cot 45°	3000	0,090	0,085	0,100	0,195	0,255	0,395	0,650	0,800	1,190	2,100	3,400	9,150
	6000	0,095	0,120	0,230	0,335	0,540	1,000	1,120	2,070	2,705	3,750	6,300	10,500
TEE teu	3000	0,135	0,115	0,180	0,315	0,415	0,620	0,975	1,350	1,965	2,785	5,550	12,400
	6000	0,140	0,235	0,390	0,590	0,880	1,520	1,750	3,480	3,900	7,250	11,000	18,700
REDUCING TEE teu redus	3000	-	0,150	0,200	0,355	0,460	0,740	1,115	1,600	2,570	3,400	6,750	15,100
	6000	-	0,235	0,400	0,600	0,880	1,590	1,820	3,820	4,220	8,100	12,350	20,900
CROSS cruce	3000	0,150	0,140	0,180	0,340	0,450	0,750	1,200	1,720	2,450	3,600	7,400	16,500
	6000	0,186	0,310	0,490	0,760	1,100	2,000	2,225	4,480	5,200	9,500	14,600	24,500
COUPLING mufe	2/3000	0,040	0,055	0,070	0,125	0,185	0,275	0,385	0,460	0,925	1,325	1,550	3,000
	6000	0,150	0,075	0,100	0,170	0,245	0,420	0,490	0,710	1,405	1,900	2,250	4,200
REDUCING COUPLING mufe reduce	2/3000	-	0,060	0,085	0,170	0,210	0,395	0,490	0,635	1,235	1,600	2,150	3,900
	6000	-	0,090	0,120	0,200	0,280	0,485	0,650	0,900	1,645	2,500	3,000	5,800
HALF COUPLING	2/3000	0,050	0,060	0,085	0,145	0,205	0,325	0,460	0,575	1,040	1,605	2,125	3,850
	6000	0,060	0,085	0,150	0,210	0,300	0,485	0,620	0,815	1,635	2,200	2,650	5,000
CAP capac	2/3000	0,030	0,035	0,075	0,105	0,165	0,245	0,380	0,720	0,955	1,350	2,115	3,300
	6000	0,040	0,075	0,110	0,150	0,250	0,400	0,565	0,920	1,320	2,000	3,250	4,800
UNION holender	2/3000	0,190	0,180	0,230	0,345	0,520	0,750	1,225	1,620	2,420	4,650	7,500	13,900
	6000	-	0,385	0,420	0,900	1,650	2,160	2,050	3,200	6,750	-	-	-
CONCENTRIC AND ECCENTRIC SWAGE NIPPLE	STD	-	0,042	0,063	0,090	0,120	0,215	0,330	0,450	0,910	1,320	2,300	3,100
	XS	-	0,050	0,075	0,105	0,170	0,280	0,410	0,610	1,075	1,710	2,825	4,250
	160	-	-	-	0,115	0,180	0,315	0,530	0,755	1,655	2,250	4,000	5,850
	XXS	-	-	-	0,140	0,245	0,400	0,790	0,975	1,970	3,000	5350	7,700
REDUCER INSERT	3000	-	0,040	0,055	0,060	0,90	0,170	0,240	0,360	0,725	-	-	-
	6000	-	0,060	0,080	0,090	0,140	0,260	0,370	0,540	1,050	-	-	-
90° BRANCHES SW & THR. END	3000	-	0,075	0,115	0,130	0,195	0,370	0,500	0,750	1,075	1,640	2,720	4,020
	6000	-	0,160	0,180	0,285	0,405	0,670	0,950	1,130	3,100	-	-	-
90° BRANCHES BW END	STD	-	0,075	0,060	0,090	0,120	0,265	0,390	0,500	0,900	1,120	1,800	3,550
	XS	-	0,050	0,070	0,100	0,140	0,290	0,420	0,560	0,990	1,220	2,000	3,800
	160	-	-	-	0,130	0,160	0,330	0,600	0,800	1,200	1,650	2,870	4,700
	XXS	-	-	-	0,150	0,185	0,365	0,670	0,880	1,330	1,770	3,150	5,200
MM	6	8	10	15	20	25	32	40	50	65	70	100	